

County Roads in Township N^o 58 North Range N^o 98 West of the 6th Principal Meridian, ~~Big Horn~~ County, Wyoming

PARK

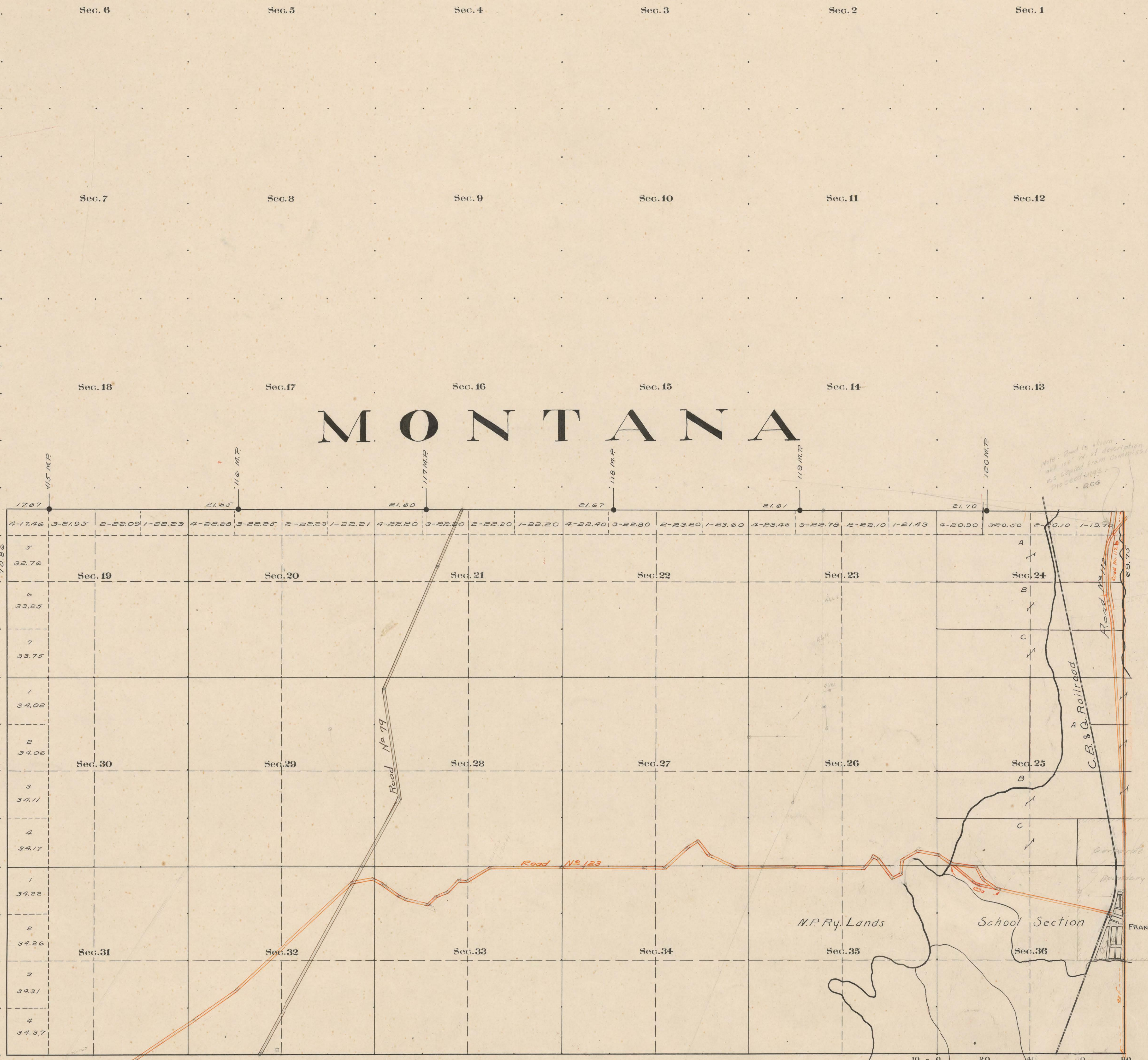

RECORD OF ROADS										VACATION.		
ROAD NO.	JOURNAL VP	PAGE	WHEN PETITIONED	WHEN ALLOWED	ORIGINAL PETITION ON FILE	SUMT. ON FILE	REMARKS	JOURNAL NO.	PAGE	DATE		
PARK COUNTY												
79	1	287	4/1/18	3/4/18	Yes	60	Colocat					Bench Road
112	2	336	5/2/26	8/1/26	Yes	100	Street Highway					
123	2	337	5/1/26	8/1/26		60						
123	3	443	1/3/28	2/7/28		60	Revised - 21					
112a	5	60		12/1/21		100	Revised of same North Ed.					
112a	3	46	4/1/22	4/1/22		100	Revised of same North Ed.					
123a	7	363	4/1/28	4/1/28		60	Revised of same North Ed.					

Scale 20 Chains to an inch

The above Map of County roads in Township No. 58 North of Range No. 98 West of the 6th Principal Meridian, is strictly conformable to the field notes of the surveys on file in this office which have been examined and approved.

County Surveyors Office
Basin, Wyoming. Sept. 8 1911

Clyde W. Attebery
County Surveyor.